

Brass Cylinders

1549

Key-In-Deadbolt Replacement Cylinder

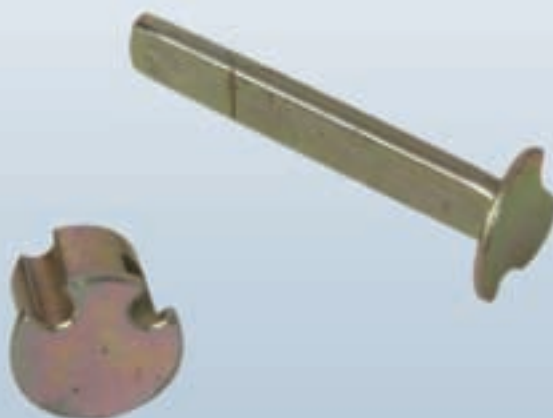

The Ilco 1549 cylinder fits Corbin/Ruswin (DL2100, DL3100) and Yale (3500, 3600), single and double cylinder deadbolts.

The  to your success



A member of the Kaba Group
www.kaba-ilco.com

1549 Key-in-Deadbolt Replacement Cylinder

The 1549 cylinder fits Corbin/Russwin (DL2100, DL3100) and Yale (3500, 3600), single and double cylinder deadbolts. A tailpiece and metal adapter are included with each cylinder.

The 1549 tailpiece is constructed from cold-headed, solid brass stock for the strongest, best design available in the replacement market today. A screw-on cap plug/tailpiece retainer insures an easy installation and secures the tailpiece more effectively than competitive models.

- Drilled 6, pinned 5
- Available in 32 popular keyways
- Master Key and Grand Master Key compatible into OEM systems
- Screw-on cap plug/tailpiece retainer
- Tailpiece and adapter included



Available Keyways

Arrow 1179	AA	Russwin D1	RB
Corbin 59 A1-2	CD	Russwin 981/852	RC
Corbin 60	CA	Composite	
Corbin 67	CB	Sargent LA	GA
Corbin 77	CC	Sargent LA-LC	GB
Corbin/Russwin L4	CE	Sargent RA-RC	GC
Dexter 67	XE	Schlage C-L	SX
DO5-DO6	DB	Schlage E	SE
Dominion 1054F	DA	Schlage F	SF
Ilco Composite	NA	Schlage C	SC
Kwikset 1176	KS	Segal 9	FA
Lockwood 1004	LA	Weiser/Falcon E	WA
Lori 80	UE	Weiser 1555	WE
Lori Centric 90	UD	ILCO X1054K	UA
Lori Composite	NB	Yale 8 (5 pin only)	YA
Lori L100	UB	Yale GA (5 pin only)	YG
Russwin 981R	RA		

